



# **Hydraulics**

## **Gear Pumps & Motors**

**Series 500 / 600**

## Aluminium gear pumps and motors series 500



Gear products series 500 are an advanced version of the bushing pumps and motors proven worldwide.

They show excellent performance, high overall efficiency, and low noise at high operation pressure levels. The product range includes 4 sizes (PGP/M 503, PGP/M 505, PGP/M 511 and PGP/M 517).

To fulfil all demands worldwide, a variety of standard models are available.

### Quality pays

- Up to 275 bar constant operation possible due to high-quality materials
- Low noise levels even in constant operation
- High efficiency thanks to precise manufacturing
- Complete product range for huge variety of applications
- Common inlet ports for double and triple pumps
- Wide choice of integrated valves, e.g. load-sensing and solenoid types
- Full range of proven motors available

### Optimized low-noise 'Split-Gear' pumps

Aluminium or cast-iron bodied 'split-gear' gear pumps are designed for high pressure and speed ratings together with high efficiency and optimised noise levels.

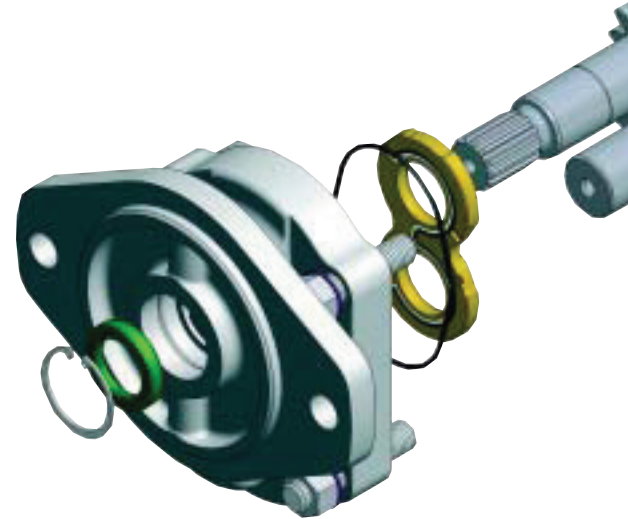

## Characteristics series PGP/PGM 500/600

Design	Mounting	Shaft style	Ports	Speed [U/min]	Inlet pressure [bar]
PGP/M 500	SAE flanges rectangle flange	SAE shaft DIN shaft	SAE, metric, BSP, UNF/UNC	500 to 4000	0.8 to 2
PGP/M 600	SAE flanges rectangle flange	SAE shaft DIN shaft	SAE, metric, BSP, UNF/UNC	500 to 4000	0.8 to 2

# er in highest Quality

## Cast-iron gear pumps and motors series 600

For many years, Parker has supplied gear pumps and motors in aluminium and Cast-iron housings for industrial and mobile applications. These products are utilised in discharge, construction and agricultural equipment.

The Parker strategy of offering technical solutions and flexible manufacturing has resulted in a wide range of options which are now available in 2 standard sizes from 16 to 80 cm<sup>3</sup>.

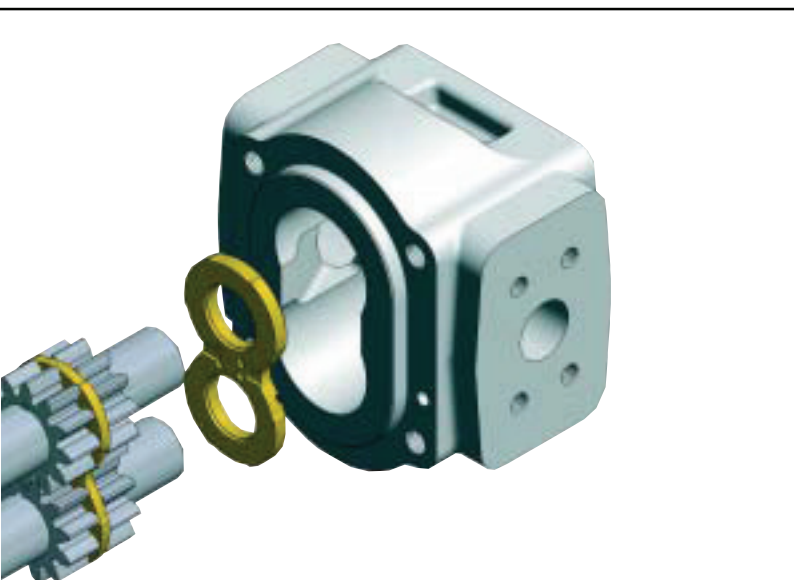

The flow pulsation is considerably decreased by phased dual element gear sets, resulting in models with clearly lower noise levels.

Common inlet available for multiple section units.

### Quality pays

- Patented two-piece modular design plus the compulsory mesh between casing and flange, for fewer points of leakage and more rigidity in the whole unit
- 12-teeth gears
- Axial clearance compensation through bronze pressure plates for high all-over efficiency
- Double or triple pumps possible
- Stackable with other products
- Common inlet ports for double and triple pumps available
- Constant pressure up to 310 bar admissible
- Wide range of integrated valves, e.g. relief valves, priority flow dividers, unloader valves
- Load-sensing and solenoid valves available
- Full range of robust motors available for high-demand applications

Hydraulic fluids	Fluid temperature [°C]	Fluid viscosity [mm <sup>2</sup> /s]	Ambient temperature [°C]	Filtration	Direction of rotation
Hydraulic oil, H-LP DIN 51525	-15 to +80	8 to 1000	-40 to +70	Acc. to ISO 4406 Class 16/13	variable
Hydraulic oil, H-LP DIN 51525	-15 to +80	8 to 1000	-40 to +70	Acc. to ISO 4406 Class 16/13	variable

anything  Possible.

**Parker Hannifin GmbH**  
Hydraulic Controls Division  
Gutenbergstr. 38  
41564 Kaarst, Germany  
Phone: +49 (0) 2131-513-0  
Fax: +49 (0) 2131-513-230  
infohcd@parker.com  
www.parker.com/eu

Bulletin HY11-3287/UK,  
01/05  
© Copyright 2005  
Parker Hannifin  
Corporation  
All rights reserved.